

MAXIPULL LEVER BLOCKS

These blocks have been tried and tested in the tough ship-building industry, and are **heavy duty** units able to cope with hard South African conditions. They are manufactured to ISO 9002 certified quality system standards.

FEATURES INCLUDE:

- Forged steel welded hook casings in place of cast casings.
- Fast free-wheeling system, ensuring minimum operating time.
- Forged steel, heat treated load sheaves for longer service and high fatigue resistance.
- Fail-safe mechanisms to prevent loads from slipping or falling.



SPECIFICATIONS

Model	Capacity (ton)	Load chain falls	Levering effort (kg)	Drawn-up height (mm)	Weight c/w 3m pull (kg)
81015	1,5	1	21	370	13
81030	3	1	34	450	22
81060	6	2	36	580	37

SEE OVERLEAF FOR PARTS LIST

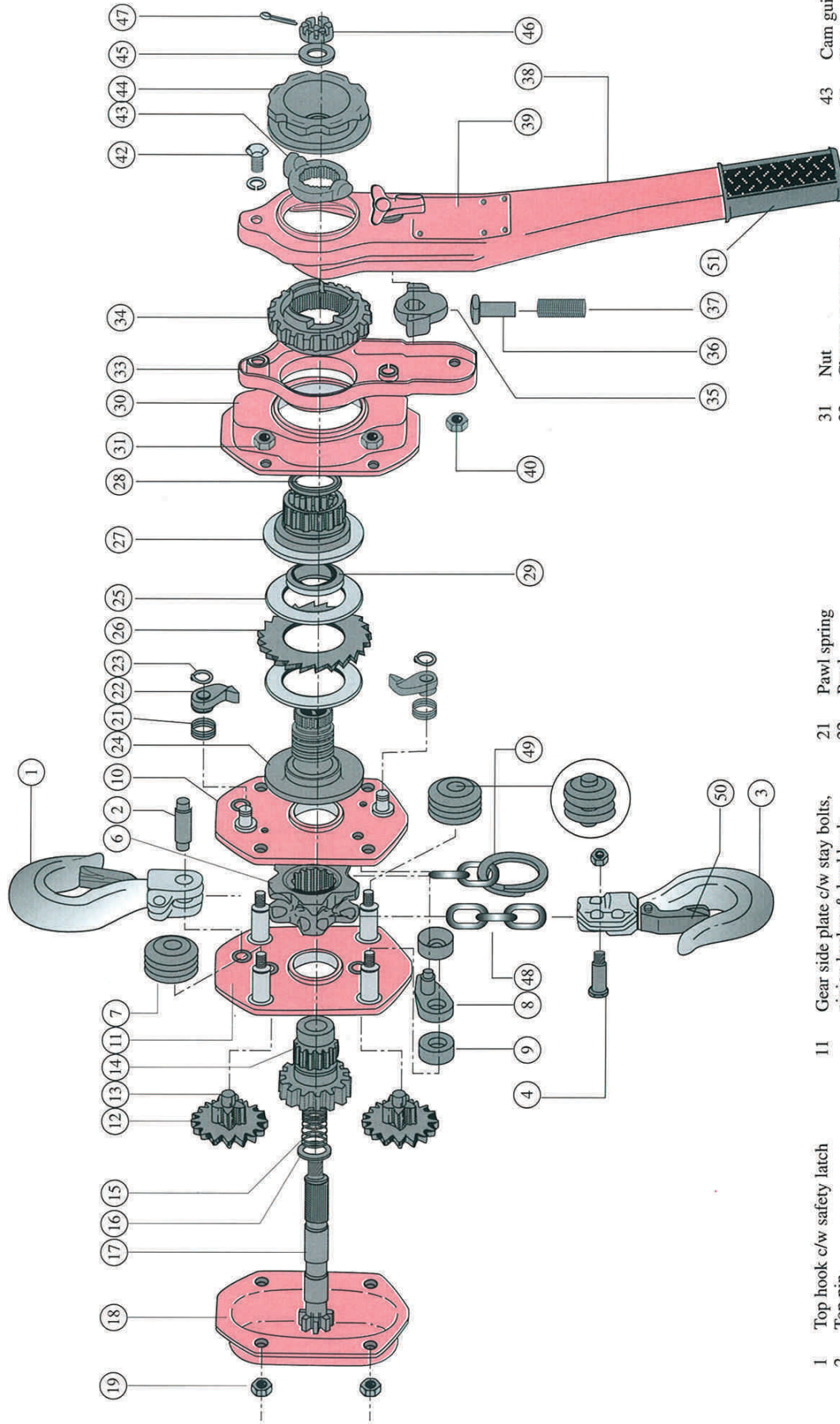

- | | |
|----|---|
| 1 | Top hook c/w safety latch |
| 2 | Top pin |
| 3 | Bottom hook c/w safety latch |
| 4 | Bolt & nut for load chain |
| 6 | Load sheave |
| 7 | Guide roller |
| 8 | Stripper |
| 9 | Stripper collar |
| 10 | Brake side plate c/w pawl studs & load bush |
| 11 | Gear side plate c/w stay bolts, pinion bushes & load bush |
| 12 | Pinion gear |
| 13 | Pinion |
| 14 | Load gear |
| 15 | Coil spring |
| 16 | Spring seat |
| 17 | Pinion shaft |
| 18 | Gear cover c/w pinion bushes |
| 19 | Nut |
| 21 | Pawl spring |
| 22 | Pawl |
| 23 | Snap ring for pawl |
| 24 | Disc hub |
| 25 | Friction plate |
| 26 | Ratchet |
| 27 | Female thread assembly |
| 28 | Seal A |
| 29 | Seal B |
| 30 | Brake cover |
| 31 | Nut |
| 33 | Change-over cover |
| 34 | Change-over wheel |
| 35 | Change-over pawl |
| 36 | Spring shaft |
| 37 | Change-over spring |
| 38 | Lever assembly |
| 39 | Nameplate & rivets |
| 40 | Nut |
| 42 | Hex head bolt & washer |
| 43 | Cam guide |
| 44 | Free knob |
| 45 | Pinion shaft washer |
| 46 | Pinion shaft nut |
| 47 | Split pin |
| 48 | Load chain |
| 49 | Chain stopper link |
| 50 | Safety latch |
| 51 | Rubber handle grip |